

# K&F SPECTRA 212i N with VariQ Technology



- Convertible Line Array Speaker
- Compact three-way, high-performance top with patented VariQ Technology
- Flexible useable as Line- and Point-Source
- High directivity and pattern control
- High output (141 dB) at low weight (48 kg)
- Operation with K&F SystemAmps



The K&F SPECTRA 212i N is a compact, three-way, high-performance top that provides very high performance with the best possible dispersion in a compact form factor. Thanks to the integrated K&F VariQ technology, the K&F SPECTRA 212i N can be used as a line array, or line source cluster and as a stand-alone point source speaker. To this end, the patented K&F VariQ unit is rotated 90° in just a few steps to switch between point source and line source operation.

The absolutely exemplary radiation behaviour in both operating modes makes the K&F SPECTRA 212i N ideal as a tool for demanding sound reinforcement tasks, especially in acoustically difficult environments. The three-way system features two 12" woofers in a bass-reflex cabinet, six 5" mid-range speakers in a closed cabinet, and four 1" compression drivers on a K&F Waveformer. As a result, the design of the speaker allows for an extremely distortion free sound reproduction over the entire frequency spectrum. The K&F SPECTRA 212i N is powered by the proven K&F SystemAmp power amplifiers. Two processed amp channels are used to drive the speaker, which ensures the best possible performance and reliability.

The design of the K&F SPECTRA 212i N provides a sonically impressive experience. All details of the source material are transmitted to the audience transparently and in detail. The large dynamic range and very high achievable levels allow for versatile applications. From small club gigs to large sound systems – the system's sound remains absolutely neutral in every situation.

In point-source mode, a K&F SPECTRA 212i N emits 60° horizontally and +5/-25° vertically. This makes it possible to use a K&F SPECTRA 212i N as a single high performance top. The asymmetrical vertical radiation helps in pointing the sound to the audience while removing unwanted ceiling reflections. Optionally, the VariQ can also be used with upward asymmetric radiation + 25° / -5°.

In line-source mode, a K&F SPECTRA 212i N emits 30° horizontally and 60° vertically. With the housing angles and the connection mechanism horizontal and vertical arrays can be formed, as well as point source clusters. The system adapts to the requirements, depending on the desired coverage and maximum sound pressure.

## K&F SPECTRA 212i N with VariQ Technology

<b>Design</b>	Passive 3-way system, 2-way active processed, LF bass reflex, MF Closed, HF waveformer horn loaded	
<b>Operation with</b>	K&F PLM+ Series, K&F D Series (recommended) K&F SystemRack (supported)	
<b>Frequency Response ±10 dB</b>	Full Range: 56 Hz – 20 kHz Low Cut: 83 Hz – 20 kHz	
<b>Frequency Response ±3 dB</b>	Full Range: 65 Hz – 18 kHz Low Cut: 125 Hz – 18 kHz	
<b>Nominal Coverage Angle (H x V)</b>	Line Source: 30° x 60° Point Source: 60° x +5°/-25° Convertible trough rotation of the VariQ unit	
<b>Nominal Power Handling</b>	2 x 500 Watt	
<b>Program Power Handling</b>	2 x 1.000 Watt	
<b>Peak Power Handling</b>	2 x 2.000 Watt	
<b>Maximum SPL (Peak @ max. 10% THD)</b>	Point Source: 141 dB SPL 1 x Line Source (30°): 143 dB SPL 2 x Line Source (60°): 145 dB SPL 3 x Line Source (90°): 146 dB SPL 4 x Line Source (120°): 147 dB SPL	
<b>Nominal Impedance</b>	2 x 8 Ω	
<b>Loudspeaker/Channel</b>	2 recommended, max. 3 per channel	
<b>Components</b>	2 x 12" LF, 6 x 5" MF, 4 x 1" HF	
<b>Connectors</b>	speakON NL4 (1+/1- LF + HF // 2+/2- MF)	
<b>Enclosure</b>	Frame-reinforced 15mm Multiplex enclosure with 30° angle for ideal cluster setups with highly resistant Polyurea synthetic coating in black, convertible between line source and point source through rotation of integrated VariQ unit, 40 M8 mounting points for dedicated accessories, ball proof steel grille with acoustic foam behind the grille.	
<b>Dimensions (W x H x D)</b>	460 x 800 x 460 mm	
<b>Weight</b>	48 kg	
<b>Colour</b>	RAL 9005 (black) RAL special colour upon request	

## SPECTRA 212 LINE SOURCE

Horizontal coverage pattern

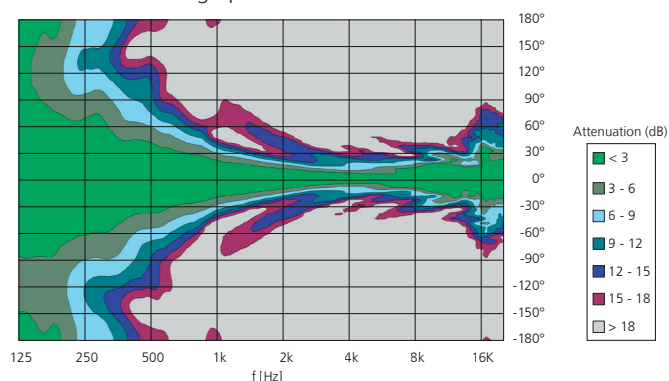

## SPECTRA 212 POINT SOURCE

Horizontal coverage pattern

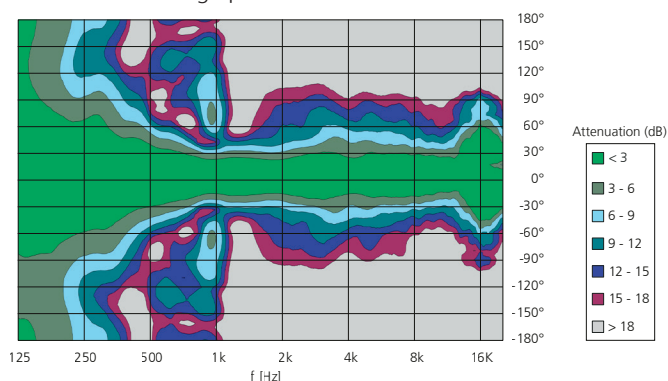

Vertical coverage pattern

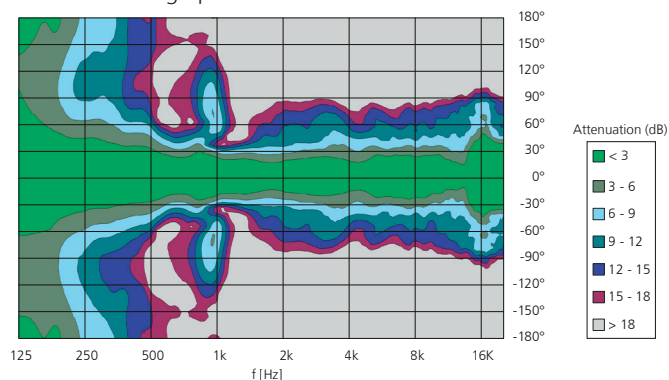

Vertical coverage pattern

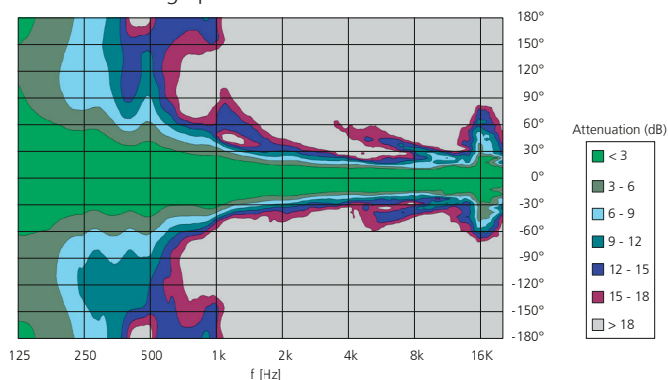

Frequency response 'on axis' Line Source

— Frequency response  
— Frequency response LCut

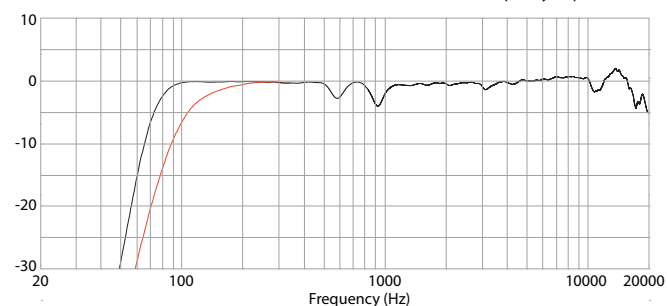

Frequency response 'on axis' Point Source

— Frequency response  
— Frequency response LCut

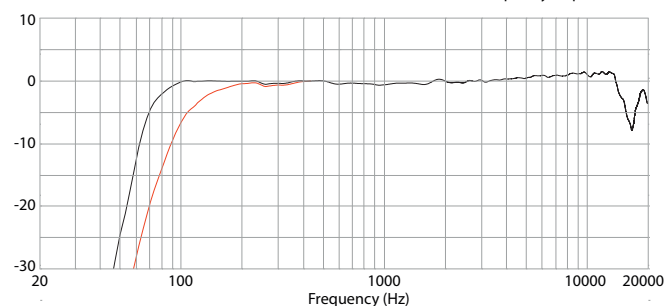

# K&F SPECTRA 212i N with VariQ Technology

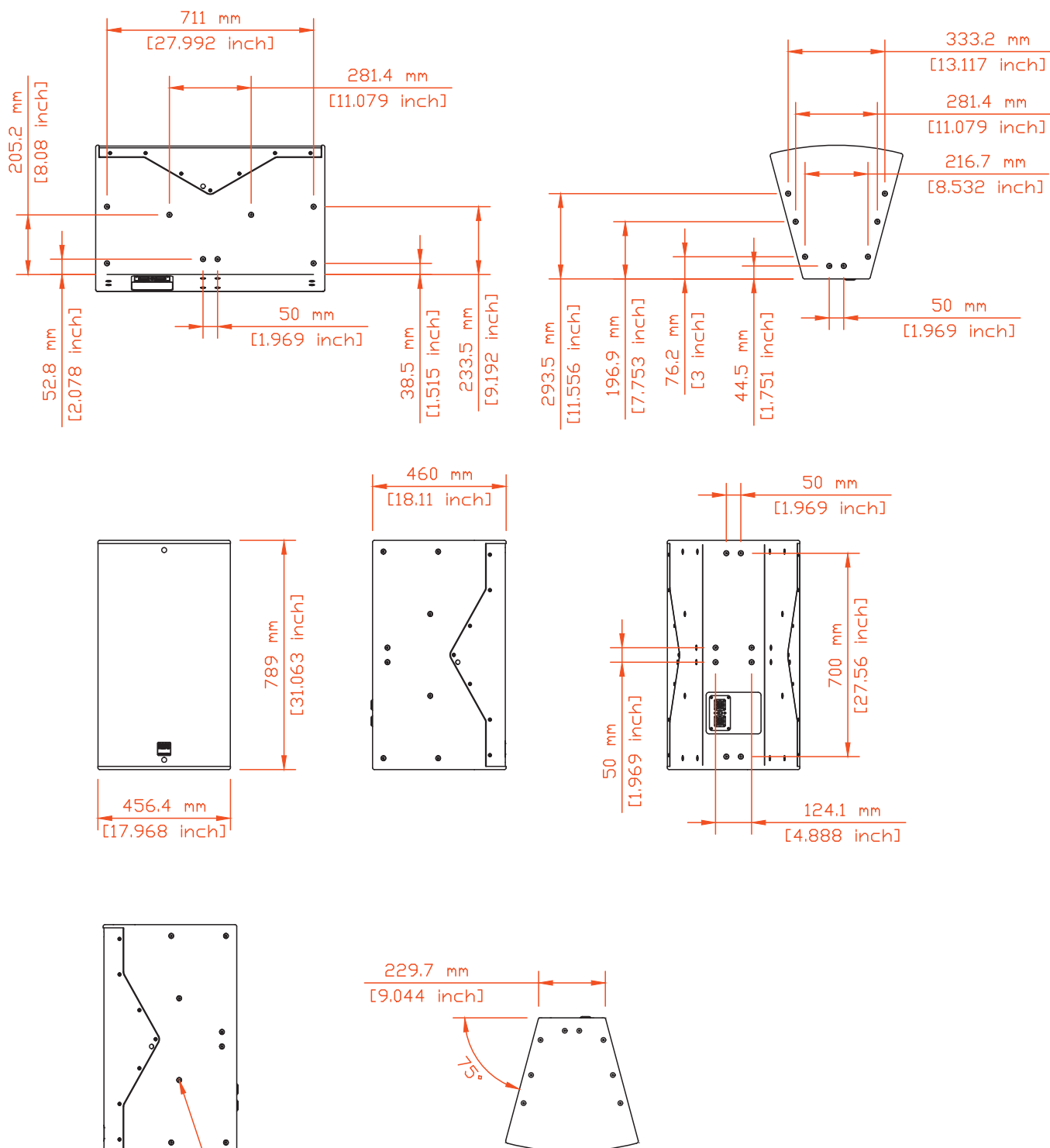

Countersunk screws M8 x 35 with TufLok-spot.  
The screws are equipped with a screw lock